

DESCRIPTION

This is a 1050 nm Infrared 1206 package surface mount LED optimized for applications requiring a small, Infrared LED.

FEATURES

- 1050 nm Infrared emission
- 0.3 mw typical Output Power
- 60 Degree Half angle of light emission
- Low cost 1206 surface mount package

ABSOLUTE MAXIMUM RATINGS

- Storage temperature..... -550°C to +100°C
- Case operating temperature -40°C to +85°C
- Lead solder temperature..... 260°C, 10 seconds
- Continuous forward current..... 100 mA
- Reverse Voltage..... 3 Volts

PARAMETER	TEST CONDITION	SYMBOL	MIN	TYP	MAX	UNIT
Forward Voltage	If = 100 mA	V_f		1.2	2.0	Volts
Reverse Voltage	I _r = 10 µA	V_r	3.0			Volts
Half Angle at Half Power		$\theta_{1/2}$		60		DEG
Capacitance	$V_r = 0 V, f = 1 MHz$	C		70		pF
Total Optical Power	If = 100 mA	P_{out}	0.1	0.3		mW
Peak Wavelength	If = 100 mA	λ_p	1020	1050	1080	nm
Spectral Bandwidth	If = 100 mA	$\Delta\lambda$		145		nm
Electrical Bandwidth	If = 100 mA	BWE		85		MHz
Response Time	10%-90%, 1 V Prebias If = 100 mA	t_r t_f		20 20		nsec nsec

ELECTRO-OPTICAL CHARACTERISTICS (Case T = 25°C)

distributed by



Ohmstrasse 4
 85716 Unterschleissheim
www.imm-photonics.de

Tel.: +49 89 3214120
 Fax.: +49 89 32141211
sales@imm-photonics.de

OUTLINE DIMENSIONS

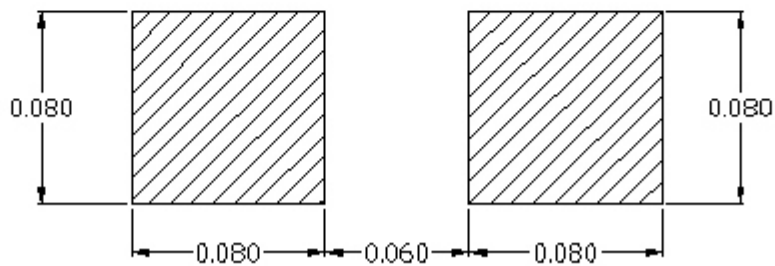
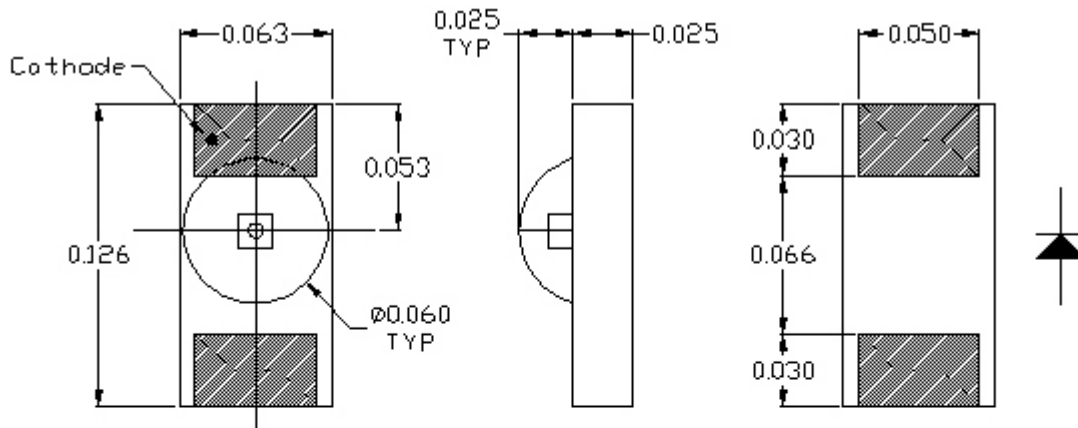

Recommended Reflow Solder Pad Pattern

Tolerances are +/-0.005 inches, except as noted

Pinout

- 1. Cathode
- 2. Anode

distributed by